

CITY MAP OF GROVES

SCALE: AS SHOWN
DWN. BY: DKR

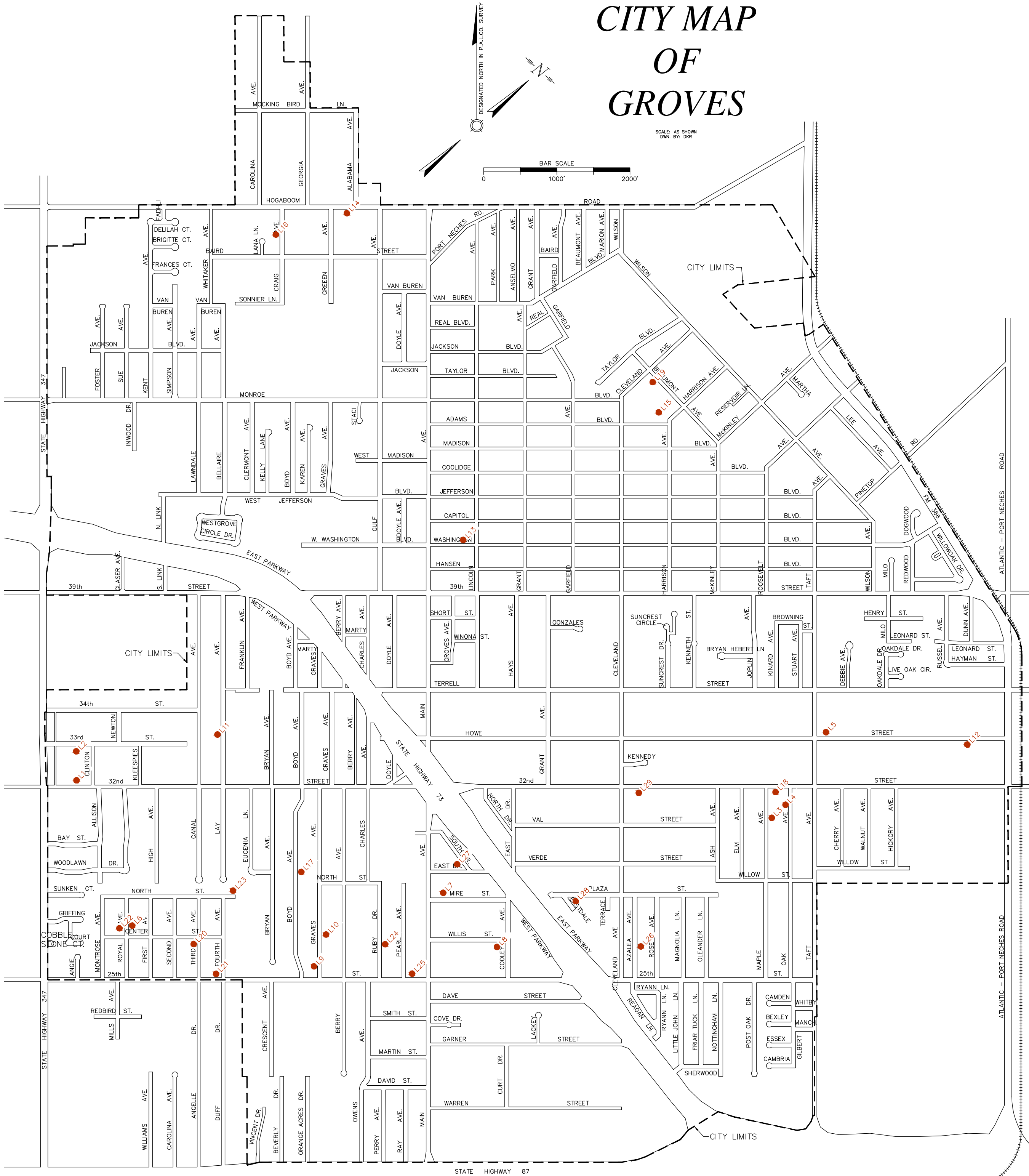
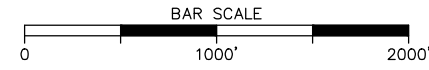

Razed Homes				
City of Groves				
Property With Liens as of February 2014				
(values are rounded to the nearest whole number)				
Property Address	Owner Name & Address	Legal Description	Taxes Owed	Lien Amount
L1 5029 32nd Street	BLAKE E ROOT & JASON ROOT 2324 FRANKLIN AVE NEDERLAND, TX 77627	LT 4 BLK 4 ATLANTIC GARDENS	\$4,958	\$12,980
L2 5028 33rd Street	LENA M FLORES	LT 9 BLK 4 ATLANTIC GARDENS	\$10,721	\$12,364
L3 3210 Maple Ave.	WILLARD W SPELL 610 AVENUE J SOUTH HOUSTON, TX 77587	LT 9 N60' BLK 3 CEDAR CREST	\$21,205	\$4,423
L4 3243 Oak Ave.	DANIEL WEEKS (CD) JOHN F PAULS (LH)	LT 39 BLK 3 CEDAR CREST	\$13,221	\$5,489
L5 6915 Howe Street	JEFFERSON COUNTY 1149 PEARL ST BEAUMONT, TX 77701	LT 36 S150' BLK 4 C C ESTATES	\$18,737	\$3,779
L6 2720 Royal Ave.	BE NGUYEN ET UX	LT 14 & LT 15 BLK 5 FAIRHAVEN	\$20,640	\$10,921
L7 6121 Mire Street	DAVID CHRISTOPHER CLUCK 1424 N 22ND ST NEDERLAND, TX 77627	LT 2 R55 & LT 3 R100 GARDEN FARMS 6119-6123 MIRE	\$1,838	\$7,880
L8 6234 Willis Street	MARC S FULK 10000 WINZER RD BEAUMONT, TX 77705	N167.5' LT 85 GARDEN FARMS	\$535	\$3,525
L9 2645 Graves Ave.	FANNIE MAE AKA FEDERAL NTL MORTG ASN PO BOX 650043 DALLAS, TX 75265	LT 3 KENTWOOD ADD	\$6,039	\$5,855
L10 2736 Graves Ave.	JOE MASON	S55' OF LT 28 BLK KENTWOOD ADD	\$1,247	\$6,084
L11 3411 Lay Ave.	JEAN B VEILLON PO BOX 1505 GROVES, TX 77619	LT 18 BLK 2 LAY ADDITION	\$1,762	\$4,169
L12 7160 Howe Street	ALPHA P MYERS 3206 SEATTLE ST NEDERLAND, TX 77627	LT 73 BLK 4 C C ESTATES	\$1,685	\$4,410
L13 6189 Washington Blvd.	RANDALL & PRISCILLA HARVEY	LT 10 S1/2 LT 9 S1/2 OF E42' BLK 18 PECAN GROVES	\$2,740	\$4,510
L14 5834 Hogaboom Road	WILLIAM LANGSTON LOWRANCE	LT 4 BLK 2 GROVES ACRES	\$6,042	\$5,110
L15 4725 Harrison Ave.	BAYVIEW FINANCIAL PROPERTY TRUST 4425 PONCE DE LEON BLVD # 500 CORAL GABLES, FL 33146	LOT 9 BLK 8 LEE TO GROVES	\$0	\$5,110
L16 5499 Craig Ave.	BENJAMIN PAUL LEBLEU PO BOX 138 NEDERLAND, TX 77627	LT 10 N75 BLK 4 GROVES ACRES	\$1,165	\$5,110
L17 3020 Boyd Ave.	JEFFERSON COUNTY 1149 PEARL ST BEAUMONT, TX 77701	LT 15 BLK 2 BOYD	\$8,246	\$4,573
L18 6820 32nd Street	RICHARD LEE FAULK ESTATE 6820 32ND ST GROVES, TX 77619	LT 3 BLK 3 CEDAR CREST	\$8,898	\$5,572
L19 4887 Beaumont Ave.	JEFFERY SCOTT POPE 205 9TH AVE NEDERLAND, TX 77627	LOT 1&2 E50 OF W160 BLK 8 LEE TO GROVES	\$0	\$8,644
L20 2649 Third Ave.	BLAINE WELTY 3303 AVENUE D NEDERLAND, TX 77627	LT 11 BLK 3 LYNDALDE	\$1,031	\$8,978
L21 5349 25th Street	JOHN ORVILLE BESWICK 1210 CEDARVIEW DR JEFFERSONVILLE, IN 47130	LT 19 & LT 20 BLK 4 LYNDALDE	\$15,092	\$6,273
L22 2701 Royal Ave.	PAULA CHARDIN SHELDON CHARDIN ESTATE 7390 PINDO CIR APT 161 BEAUMONT, TX 77708	LT 20 BLK 3 FAIRHAVEN	\$8,430	\$4,495
L23 5445 North Street	ROY & E LOUISE CASTANEDA 5501 W WASHINGTON #113 GROVES, TX 77619	LT 26 BLK 10 LYNDALDE	\$15,522	\$4,495
L24 2734 Ruby Dr.	RICHARD DALEY PO BOX 643 NEDERLAND, TX 77627	LT 34 W1/2 PEARL GARDENS	\$1,059	\$3,546
L25 6025 25th Street	MAX & TASHA SMITH 2311 TAFT AVE GROVES, TX 77619	TRACT 51-A REPLAT OF LTS 49&51 PEARL GARDENS .5948 AC	\$0	\$6,281
L26 2720 Azalea Ave.	CARDEN D HENNING 10110 LAMB BROOK LN PEARLAND, TX 77584	LT 7 BLK 2 PLAZA TERRACE NO 1	\$0	\$7,009
L27 3027 South Dr.	DOYLE C HOLMES 3027 SOUTH DR GROVES, TX 77619	LT 17 E42 BLK 5 EAST PORT ARTHUR	\$21,972	\$4,930
L28 6348 Plaza Street	DAVID L & CLARA JEFFREY 6310 VAL ST GROVES, TX 77619	LT 1 BLK 3 RAINBOW	\$0	\$13,035
L29 6524 32nd Street	GREGORY A OATIS DBA SUPERIOR CONSTRUCTION 6916 TERRELL ST GROVES, TX 77619	LT 4 BLK 2 VAL VERDE GARDENS	\$450	\$10,959